

Industry Studies Association Annual Conference June 4-6, 2025



~WELCOME~

John Gray, President of the Industry Studies Association

Thank you all for making the Industry Studies Association part of your conference circuit. We are delighted to welcome you to MIT for an engaging few days of panels, plenaries, paper sessions, tours, and, most importantly, conversations in the hallways and at our receptions.

Due to the multiple disciplines represented at our conference, and the unifying trait of deeply understanding the context of research, our conference conversations are second to none. You can learn about a phenomenon in another industry that relates to your interests or hear from someone studying your industry from another disciplinary context. That simply does not happen in most conferences.

I want to thank Hiram Samel for serving as the conference chair this year. He worked diligently to put together this amazing program. I also want to thank Liz Reynolds and Ben Armstrong for sourcing several great individuals who will be speaking at the conference. More than anyone, John Paul MacDuffie deserves an incredible thank you for going way above and beyond the call over the last 1-2 years as we've operated without a program manager until very recently.

On that note, I am very excited to welcome Renae Sullivan, our new program manager. Renae started just in April and has been drinking from a fire hose as she has played many key roles in helping us deliver this conference. We are very happy to have her onboard, and we think you will notice improvements in many aspects of ISA in the coming months. I also am happy to report that Ed Anderson of Texas has joined us as Vice President/President-Elect. He is slated to take over from me as President after next year's conference. Other additions to the board in the last year include Benn Lawson of Oxford on non-US strategy, Jeff Shockley of Virginia Commonwealth as treasurer, Raja Roy of NJIT on awards, and Darcy Fudge Kamal of Cal State-Sacramento on membership. Additionally, Anant Mishra of the University of Minnesota started his three-year stint on the conference committee, agreeing to be the chair in 2027.

We will have not one, but two major conferences next year. The first will be our usual annual conference in 2026 around this time in Washington, D.C.; John Paul Helveston of George Washington U. will chair that conference. We will also have our first international conference in Oxford, UK in early September 2026, chaired by Benn Lawson of Oxford. Please look for more details soon!

I am very happy you are here, and hope you enjoy the conference, MIT, Cambridge, and the great city of Boston.

John Gray
President, ISA



Conference in Brief

CONFERENCE LOCATION

Massachusetts Institute of Technology (MIT) Samberg Conference Center (E52)

50 Memorial Drive
Cambridge, MA 02142

PAPER PRESENTATION LOCATIONS

Tang Center (E51), 70 Memorial Drive
1ST and 3rd Floors

MIT Sloan (E62), 100 Main Street
2nd Floor

BUS STOP LOCATION FOR EXCURSIONS

Muckley Building (E40)

Intersection of Amherst Street and Wadsworth Street

REGISTRATION

Wednesday, June 4

Thursday, June 5

Friday, June 6

7:30am—4:00pm Samberg Conference Center 7th Floor

7:30am—4:00pm Samberg Conference Center 7th Floor

7:30am—12:00pm Samberg Conference Center 7th Floor

WEDNESDAY, June 4

7:30am—11:30am

12:00pm—1:00pm

1:00pm—2:00pm

2:00pm—2:55pm

3:00pm—5:00pm

3:00pm—3:15pm

3:15pm—4:15pm

4:15pm—5:00pm

5:00pm—6:00pm

6:00pm—6:15pm

6:15pm—7:00pm

7:00pm—9:30pm

Factory Tours - Vulcan/CFS or MA Robotics

Lunch

Parallel Paper Session 1; Session schedule includes 5 research streams

Opening Plenary: [Digitalization, Platforms, and Ecosystems](#)

Professional Development Workshop (PDW)

Coffee/Networking

Parallel Paper Session 2; Session schedule includes 4 research streams

[The Future of Energy Panel](#)

The Future of Biotechnology Panel

Coffee/Snacks

Evening Plenary: David Mindell and Richard Lester, Book Talk & Fireside Chat

Welcome Reception: Sally Kornbluth, MIT President; ISA Honoring Richard Lester

THURSDAY, June 5

7:00am—8:00am

8:00am—9:00am

9:15am—10:15am

10:15am—10:45am

10:45am—11:45am

12:00pm—1:00pm

1:15pm—2:15pm

2:30pm—3:30pm

3:30pm—3:50pm

3:50pm—4:50pm

5:00pm—6:00pm

6:00pm—7:30pm

Breakfast

Parallel Paper Session 3; Session schedule includes 7 research streams

Special Sessions: Choice of Two Panels Ind. Policy/New Org. Structures

Coffee/Snacks

Parallel Paper Session 4; Session schedule includes 7 research streams

[Business Meeting Luncheon](#)

Parallel Paper Session 5; Session schedule includes 7 research streams

Parallel Paper Session 6; Session schedule includes 7 research streams

Coffee/Networking

Parallel Paper Session 7; Session schedule includes 5 research streams

Plenary: Industry Evolution

Drinks Networking

FRIDAY, June 6

7:00am—8:00am

8:00am—9:00am

9:15am—10:15am

10:15am—10:45am

10:45am—11:45am

12:00pm—1:00pm

Breakfast

Parallel Paper Session 8; Session schedule includes 6 research streams

Special Sessions: Choice of Two Panels Supply Chain/Workforce Development

Coffee/Snacks

Parallel Paper Session 9; Session schedule includes 7 research streams

[Awards Luncheon](#)





Conference Map

whereis.mit.edu

-  **Tang Center**
Building E51 — Remove
-  **Morris and Sophie Chang Building**
Building E52 — Remove
-  **MIT Sloan**
Building E62 — Remove
-  **Muckley Building**
Building E40 — Remove

Welcome to the MIT Campus Map.
You can pan the map by dragging it with your mouse. Enlarge (zoom) the map with the + and - controls.

Other things you can do:

- Search the map, e.g.,
welcome center
food
hotels
kresge auditorium
building 46
- Click anywhere on the campus to learn more about that location. Control-click on the resulting marker to remove it.
- Share (or bookmark) and print maps using the links in the upper-right corner.
- Show additional landmarks:
 -  Emergency Phones
 -  MIT Public Entrances

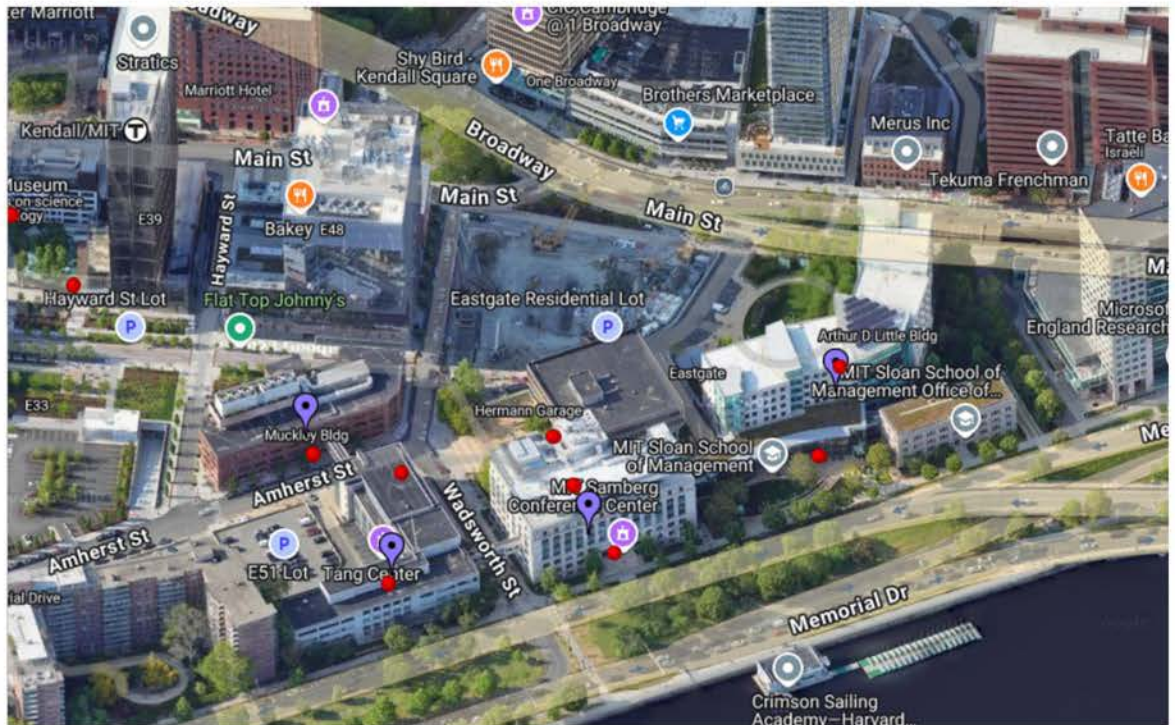

**SAMBERG
CONFERENCE
CENTER**

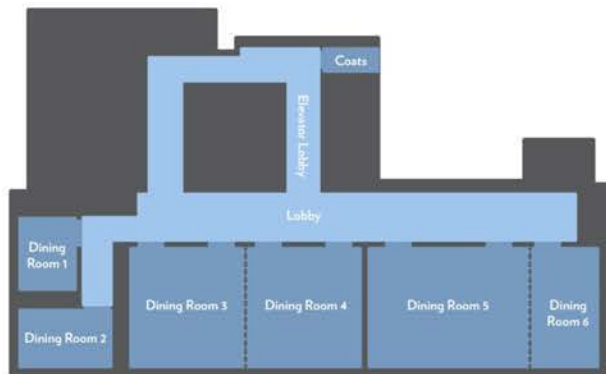

CONFERENCE CENTER 6TH FLOOR

**SAMBERG
CONFERENCE
CENTER**

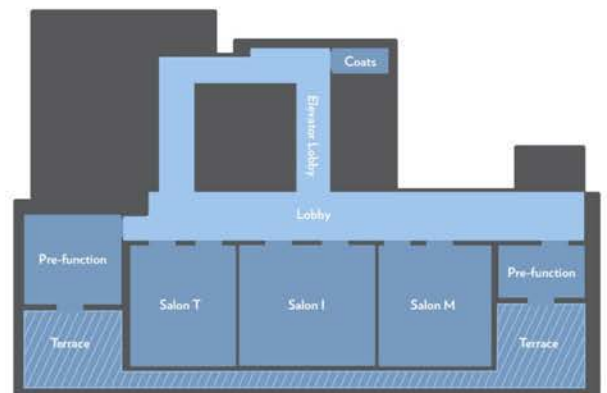

CONFERENCE CENTER 7TH FLOOR

<https://sambergconferencecenter.mit.edu/samberg-conference-center-floor-plans/>



Industry Studies Association Awards

Join us Friday, June 6th at the Awards Luncheon when we recognize all awardees.

Best Paper in Innovation and Entrepreneurship Award

This award recognizes outstanding innovation and entrepreneurship research. Papers from any research stream are eligible, including self-nominations. Winning papers must demonstrate significant personal investment in understanding industry-specific markets, firms, and institutions, typically integrating field-based research with appropriate theory and analysis, aligning with the Industry Studies Association's mission. Prizes: \$500 (first place), \$250 (runner-up).

WINNER:

"Clause and effect: Theory and field experimental evidence on noncompete clauses"
Bo Cowgill, Columbia Business School; Brandon Freiberg, Columbia Business School;
Evan Starr, Robert Smith School of Business, University of Maryland

RUNNER-UP:

"Finding Diamonds in the Rough: Data-Driven Opportunities and Pharmaceutical Innovation"
Matteo Tranchero, Wharton School, University of Pennsylvania

Award Committee: Cameron Miller (Chair), Astrid Marinoni, Jino Lu

Dissertation Award

This award recognizes outstanding doctoral research in industry studies. Eligible candidates must have completed a dissertation in economics, management, engineering, political science, sociology, or related/interdisciplinary fields within the previous 18 months. Prizes: \$500 (first place), \$250 (runner-up).

WINNER:

Hanu Tyagi (Gies College of Business, University of Illinois Urbana-Champaign; PhD, U. Minnesota)
"Balancing Novelty, Safety, and Availability: The Trifecta of Outcomes in Pharmaceutical Supply Chains"

RUNNER-UP (tie):

Jino Lu, Washington University, Saint Louis; PhD, Marshall School of Business, USC
"Three Essays on the Spillover Effects of Technological Change on Innovation Dynamics"

Alan Zhang, Columbia University; PhD, MITSloan
"Instability Scaffolding: Sustaining Craft in Unstable Environments"

Award Committee: Raja Roy (Co-chair), Alicia DeSantola (Co-chair), Jeffrey Furman (Co-chair), JK Suh, Matt Marx, Rosemarie Ziedonis, Alan Benson, Hyunjin Kim, Ronnie Lee, Gauri Subramani, Shirley Tang

Giarratani Rising Star Award

Early career scholars may submit one paper to which they've made a significant contribution. This award recognizes junior scholars conducting industry-based research that demonstrates deep knowledge through significant personal investment in understanding industry markets, firms, and institutions. Prizes: \$1,000 (first place), \$500 (runner-up).

WINNER:

Hyunjin Kim, INSEAD, "Machine Predictions and Causal Explanations: Evidence from a Field Experiment"

RUNNER-UP (tie):

Matteo Tranchero, Wharton School, University of Pennsylvania
"Finding Diamonds in the Rough: Data-Driven Opportunities and Pharmaceutical Innovation"

Christopher Eaglin, Fuqua School of Business, Duke University
"Easy Doesn't Do It: Initial Conditions, Early Strategy Selection, and Small Firm Performance"

Award Committee: Arvind Karunakaran (Chair), Christopher Law, Sukhun Kang

Thank you to all who served on an award selection committee!



Industry Studies Association Awards

Join us Friday, June 6th at the Awards Luncheon when we recognize all awardees.

Babbage International Policy Forum Industrial Innovation Policy Award

This new award, funded by the Babbage International Policy Forum (UK) under Professor Sir Mike Gregory's leadership, recognizes outstanding contributions to industrial innovation policy research. Winning papers must demonstrate deep engagement with theoretical and practical elements of industrial innovation policy and substantial commitment to understanding policy-industry dynamics. Cross-disciplinary approaches drawing from economics, science and technology, and management are encouraged, particularly those offering practical insights for policymakers and industry leaders. Prizes: \$750 (first place), \$250 (runner-up).

WINNER:

"Does Transparency Hinder Technological Novelty? Evidence from Large Pharmaceutical Firms"
Hanu Tyagi (Asst Prof, Illinois; PhD, Minnesota)

RUNNER-UP:

"Institutional Learning in the Energy Transition: The Case of U.S. Offshore Wind"
Tyler Hansen, Dartmouth College; Stephanie Lenhart, Boise State University; Aidan Muller, Dartmouth College; Elizabeth J. Wilson, Dartmouth College

Award Committee: David Hart, Canberk Ucel

Ralph Gomory Best Industry Studies Paper Award

Named for Ralph Gomory, former Alfred P. Sloan Foundation President who initiated the Industry Studies Program, this award showcases excellent industry studies research published in the preceding year across eight top academic journals. The Industry Studies Association aims to encourage researchers to submit industry studies work to leading scholarly journals while demonstrating to editors the value of deep industry context exploration. The ISA promotes research that builds practitioner relationships for primary data access, uses field-gathered contextual knowledge to inform research questions and design, and guides data analysis, interpretations, and conclusions. Prizes: \$1,000 (first place), \$500 (runner-up).

WINNER (tie)

"Giving up learning from failures? An examination of learning from one's own failures in the context of heart surgeons," 2024, *Strategic Management Journal*, 45: 2063-2094. Sunkee Lee, Carnegie-Mellon University; Jisoo Park, Clark University

"Technology-Enabled Agent Choice and Uptake of Social Assistance Programs: Evidence from India's Food Security Program," 2024, *Manufacturing & Service Operations Management* 26(4):1472-1488. Rakesh Allu, Cornell University; Maya Ganesh, Indian Institute of Management, Ahmedabad; Sarang Deo, Indian School of Business, Hyderabad; Sripad K. Devalkar, Indian School of Business, Hyderabad

RUNNER-UP (tie)

"Triadic technology configuration: A relational perspective on technologists' role in shaping cloud-based technologies," 2024, *Industrial & Labor Relations Review*, 77(3), 307-35. Jenna E Myers, University of Toronto

"Technology adoption and innovation: The establishment of airmail and aviation innovation in the United States, 1918 – 1935," 2024, *Strategic Management Journal*, 45: 3-35
Eunhee Sohn, Scheller College of Business, Georgia Tech; Robert Seamans, Stern School of Business, NYU; and Daniel B. Sands, UCL School of Management, University College London.

Award Committee: Ram Ganeshan (Chair), Ariel Avgar, Dan Armanios, Rich Metters, Shinjinee Chattopadhyay, Mike Teodorescu



Thank you to all who served on an award selection committee!

Conference Program in Detail

Research stream descriptions, abbreviations, and color key:

1. Energy, Sustainable Innovation, and Mobility (EN)

This stream invites papers and panels on the changing market and public policy landscape where the energy industry (including oil and gas, electricity, pipelines) intersects with environmental concerns.

2. General Industry Studies (GO)

Any research on issues or industries not covered in other research streams described above may be submitted to this general stream. Papers or organized panels comparing phenomena, trends, issues, or economic activities across occupations, industries, or geographic regions are especially welcome.

3. Health Care Systems, Biotechnology, and Pharmaceuticals (HC)

This stream invites papers and panels that examine the myriad of issues surrounding effective management of health care entities and systems (e.g., hospitals, medical groups, public health agencies, insurance companies, pharmaceutical firms, technology companies, etc.).

4. Innovation, Entrepreneurship, and AI-Driven Transformation (IE)

This stream invites papers and panels that examine innovation within firms and other organizations such as universities, across organizational boundaries, across country boundaries, and in new entrepreneurial ventures.

5. Labor Markets, Organizations, and the Future of Work (LM)

This stream welcomes papers and panels that examine the impacts of firm, industry, and market characteristics on labor markets, industrial relations, and/or human resource practices as well as public policy outcomes.

6. Operations, Supply Chain, and AI-Enhanced Industry 4.0 (OP)

This stream welcomes papers and panels that are concerned with the oversight, design, and control of the business processes responsible for the production of goods and services as well as those focused on coordination of (multiple) firms responsible for these business processes within a supply network.

7. Public Policy, and Global Competitiveness (PP)

Public policy – whether national, regional, local or global – often shapes opportunities for industries, including competitive options within industries and globalization of industries. In turn, wrestling with these opportunities, competitiveness and globalization have had a profound impact on the nature of industrial activity and policy.



Conference Program: Wednesday, June 4

EXCURSIONS - (preregistration required) Bus Stop Location: Muckley Bldg. (E40)

7:30am—11:30am

VulcanForms: Advanced Digital Manufacturing

9:15am—11:30am

MassRobotics: Innovation Ecosystem Hub

LUNCH & REGISTRATION

12:00pm—1:00pm

Samberg Conference Center, 7TH Floor

ISA RESEARCH SESSIONS

1:00pm—2:00pm

See Session 1 schedule; includes 5 research streams

OPENING PLENARY | “Digitalization, Platforms, and Ecosystems”

2:00pm—2:55pm

Samberg Conference Center, 7TH Floor

PROFESSIONAL DEVELOPMENT WORKSHOP (PDW) - (preregistration required)

3:00pm—5:00pm

Samberg Conference Center, 6th Floor

COFFEE/NETWORKING

3:00pm—3:15pm

Samberg Conference Center, 7th Floor

ISA RESEARCH SESSIONS

3:15pm—4:15pm

See Session 2 schedule; includes 4 research streams

ISA SPECIAL SESSION | “The Future of Energy”

4:15pm—5:00pm

Samberg Conference Center, 7th Floor

ISA SPECIAL SESSION | “The Future of Biotechnology”

5:00pm—6:00pm

Samberg Conference Center, 7th Floor

COFFEE/SNACKS

6:00pm—6:15pm

Samberg Conference Center, 7th Floor

EVENING PLENARY | "The New Lunar Society" Book Talk & Fireside Chat

6:15pm—7:00pm

Samberg Conference Center, 7th Floor

WELCOME RECEPTION

7:00pm—9:30pm

- Special Welcome - Sally Kornbluth, MIT President
- Recognition ceremony honoring Richard Lester

Samberg Conference Center, 7TH Floor



Wednesday, June 4

EXCURSIONS - (preregistration required) Bus Stop Location: Muckley Bldg. (E40)

7:30am—11:30am

VulcanForms: Advanced Digital Manufacturing Facility

9:15am—11:30am

MassRobotics: Innovation Ecosystem Hub

LUNCH & REGISTRATION

12:00pm—1:00pm

Samberg Conference Center, 7th Floor

ISA RESEARCH SESSION 1

1:00pm—2:00pm

Tang Center (E51, 3rd Floor)

Sloan (E62, 2nd Floor)

IE2. Entrepreneurship, Empowerment, & Innovation Pathways

E51-315

Chair: Abhisekh Ghosh Moulick (Baruch College CUNY)

African American Male Entrepreneurs: A Study of the Key Success Factors

Twyla Cummings (Rochester Institute of Technology, Retired)

Thomas E. Cummings (St. John Fisher University, Doctoral Graduate)

Entrepreneurship as Empowerment: Gender, Human Capital, and Entrepreneurship in Rural India

Abhisekh Ghosh Moulick (Baruch College CUNY)

Tanmay Devi (Rice University)

Temporal Compression and Capability Development in New Ventures: A Theory of Early Hiring Patterns

Temitope Oladimeji (University of Massachusetts Amherst)

Release and Catch: Employee Spinouts as External Innovation

Liyue Yan (Boston University)

Aseem Kaul (Carlson School of Management, University of Minnesota)

Brian Wu (Ross School of Business, University of Michigan)

PP4. Procurement, Capabilities, and Policy Outcomes

E51-372

Chair: Marco Cucculelli (Universita' Politecnica delle Marche)

Health Insurance and Labor Productivity: Evidence from US Manufacturing

Yasaman Asayesh (Carlson School of Management, University of Minnesota)

Anant Mishra (Carlson School of Management, University of Minnesota)

Arzi Adbi (National University of Singapore)

Artificial Intelligence and Firm Performance: Unpacking Technological Newness in Industrial Ecosystems

Marco Cucculelli (Universita' Politecnica delle Marche)

Ali Shah (Università Politecnica delle Marche - Italy)

Thommie Burström (Hanken School of Economics - Finland)

Domestic production in US critical industries: Does firm interest in resilience align with national interest in autarky?

Oliver von Dzengelevski (ETH Zurich)

John Gray (Ohio State University)

Torbjørn Netland (ETH Zurich)



PP5. Measuring the Impact of National Competitiveness Strategies

E51-376

Chair: Hal Salzman (Rutgers University)

The Game Changer's Dilemma: Anti-"Woke" Backlash to Inclusive Product Design in the Video Game Industry

Bryn Choi (University of Illinois)

Ying Li (Hong Kong University of Science and Technology)

Matthew Kraatz (University of Illinois)

Public Policy and Creation of a Global Secondary Labor Market: How U.S. student and work visa policies transformed university and IT industry business models

Hal Salzman (Rutgers University)

Ron Hira (Howard University)

From Product Category to Symbol of Nationalism: The Rise of Nationalist Entrepreneurs and "Made In USA" Narratives amid Economic De-Globalization and Political Polarization, 2000–2023

Yilang Feng (University of Illinois)

Yusaku Takeda (University of Illinois)

IE1. AI Adoption Across Settings

E51-395

Chair: Raghavan V V (Indian Institute of Management Bangalore)

Big Brother Watching? Regulation and AI adoption in Peer-to-Peer Lending Activities

Raghavan V V (Indian Institute of Management Bangalore)

Vijay Venkataraman (Indian Institute of Management Bangalore)

How Small Business Owners Are Learning, Using, and Navigating Challenges With AI Tools

Miles Chandler (ICIC)

Howard Wial (ICIC)

Dobbin Bookman (ICIC)

Multiscalar Ecosystem Dynamics of GAI Technological Advancements: Entrepreneurs, Firms, and Governments

Banu Ozkazanc-Pan (Brown University)

Damon Matteo (Fulcrum Strategy)

IE4. Funding & Accelerating Entrepreneurship

E62-262

Chair: Nathan Rietzler (Northeastern University)

The Relationship between Founders and Startup Government Innovation Funding

Jennifer Woolley (Santa Clara University)

Adele Xing (Santa Clara University)

Incentivizing Women's Entry into Entrepreneurial Finance: A Randomized Field Experiment

Anna Lukkarinen (Ivey Business School)

Markku Kaustia (Aalto University)

Accelerators Role in Propelling Innovation: What We Know and How They Differ from Venture Capital and Public Funding

Nathan Rietzler (Northeastern University)

Jacqueline Lane (Harvard Business School)



Wednesday, June 4
2:00—3:00 pm

Panelists' Bios

Opening Plenary | Digitalization, Platforms, and Ecosystems

Digitalization is transforming industries, reshaping business models, and enabling new forms of value creation whether in companies, complex organizations or industrial systems. Better data collection, transmission, and interpretation and the acceleration of AI in operations can increase quality, security, productivity and innovation and lead to the reconfiguration of organizations and work. Yet, there are challenges to this transformation: the introduction of new technologies and infrastructure, changes to jobs, roles and skills for workers as well as working across an 'ecosystem' of suppliers, partners and customers. This panel will look at the current state of digital transformation in terms of firm strategy, technology adoption, infrastructure and implications for leadership to shed light on the path forward and what risks and rewards lie ahead for firms, organizations and society writ large.



Moderator Elisabeth Reynolds - Elisabeth Reynolds is Professor of the Practice in the MIT Department of Urban Studies and Planning. She was Special Assistant to the President of the U.S. for Manufacturing and Economic Development at the National Economic Council (2021-2022) where she helped lead the Administration's work on national manufacturing strategy, supply chain resilience and industrial strategy. Before working at the NEC, Reynolds was executive director of the MIT Industrial Performance Center (2010-2021) and also co-led the MIT Task Force on the Work of the Future (2018-2021).



Geoff Parker - Geoffrey G. Parker is the Charles E. Hutchinson '68A Professor of Engineering Innovation at Dartmouth and Faculty Director of the Arthur L. Irving Institute for Energy and Society. An expert in platform economics and digital transformation, he co-authored Platform Revolution and advises global organizations on business models and energy transition strategies. He holds degrees from Princeton and MIT.



Jagjit Singh Srai - Dr. Jag Srai is a Director of Research in the Department of Engineering, University of Cambridge, and Head of the Institute for Manufacturing's (IfM's) Centre for International Manufacturing. He is also Co-Chair of the World Economic Forum's Council on Advanced Manufacturing Value Chains. Jag's research involves working closely with industry in the analysis, design and operation of international supply networks. Research areas include digital transformation of supply chains, supply network reconfiguration driven by changes to markets, technologies, and business strategy, supply network resilience and sustainable supply. Previous to IfM, Jag held senior management roles in Unilever.



Åsa Tamson - Åsa Tamsons is Senior Vice President and Head of Business Area Enterprise Wireless Solutions at Ericsson. Since joining the company in 2018, she has led strategy and investments in new growth areas, accelerating Ericsson's innovation pipeline. Previously, she was a partner at McKinsey & Company, advising global tech, telecom, and industrial firms on growth strategy and B2B sales. Tamsons holds a Master of Science in Business Administration from the Stockholm School of Economics.



Natan Linder - Natan Linder is the Co-Founder and CEO of Tulip Interfaces, a manufacturing technology company that helps global manufacturers drive Industry 4.0 and digital transformation. He is also the Co-Founder and Chairman of Formlabs, a leader in professional desktop 3D printing. With over 15 years of experience at companies like Samsung, Sun Microsystems, and Rethink Robotics, Linder specializes in computer science, product design, and entrepreneurship. He holds a Ph.D. from the MIT Media Lab's Fluid Interfaces Group and an M.Sc. in Media Arts and Sciences from MIT.

Wednesday, June 4

OPENING PLENARY | “Digitalization, Platforms, and Ecosystems”

2:00pm—3:00pm

Samberg Conference Center, 7th Floor

PROFESSIONAL DEVELOPMENT WORKSHOP (PDW) - (preregistration required)

3:00pm—5:00pm

Samberg Conference Center, 6th Floor

COFFEE/NETWORKING

3:00pm—3:15pm

Samberg Conference Center, 7th Floor

ISA RESEARCH SESSION 2

3:15pm—4:15pm

Tang Center (E51, 3rd Floor)

Sloan (E62, 2nd Floor)

HC1. Biopharmaceutical Supply Chain

E51-315

Chair: John Gray (Ohio State University)

Analysis and Policy Solutions for U.S. Generic Drug Shortages

Jeffrey Ferry (Coalition for a Prosperous America)

Badri Gopalakrishnan (Infinisum)

Pharmaceutical Supply Chains: Quality and Resilience

John Gray (The Ohio State University)

Robert Handfield (NC State University)

GO1. Assessment of Government Program and Policy

E51-372

Chair: Andrew Reamer (George Washington University)

Do Certified Development Companies Target Industries for Small Business Loans to Young Firms? Evidence from the SBA's 504 Loan Program

Christopher Smith (University of Southern Mississippi)

Professional Networks, Regulation, and the Cessation of Deviance in the Prescription Opioid Crisis

Victoria (Shu) Zhang (Northeastern University)

The inconsistency and unreliability of Federal economic statistics by NAICS codes--Extent of, Reasons for, and Efforts to address

Andrew Reamer (George Washington University)

GO7. Geopolitics and the Automotive Industry: China's Electric Vehicle Dominance and Impact of US-imposed Tariffs

E51-376

A panel discussion with:

Jinhua Zhao, Professor of City & Transportation Planning (MIT), Founder, MIT Mobility Initiative

John Moavenzadeh, Executive Director, MIT Mobility Initiative

John Paul MacDuffie (University of Pennsylvania)



Wednesday, June 4

EN2. Supply Chains, Climate and Disaster Preparedness

E51-395

Chair: Andrew Balthrop (University of Tennessee)

Strengthening Truck Stop Infrastructure for Crisis Resilience

Angella Acocella (Massachusetts Institute of Technology)

Christina Cafaro (Massachusetts Institute of Technology)

Ginny Hsiang (Massachusetts Institute of Technology)

Tim Russel (Massachusetts Institute of Technology)

The Impact of Voluntary Environmental Programs on Buyers and Suppliers: A Green Club Perspective

Andrew Balthrop (University of Tennessee)

David Cantor (Iowa State University)

Prabhjot Mukandwal (Wayne State University)

Alex Scott (University of Tennessee)

Do mandatory environmental regulations reduce firm and supply chain emissions? Evidence from the EPA's GHGRP program

David Cantor (Iowa State University)

Prabhjot Mukandwal (Wayne State University)

Sachin Modi (University of Cincinnati)

A Synthetic Control Approach to Examining the Effects of Major Hurricane Landfalls on the US Long-Haul Dry Van Truckload Spot Market

Travis Kulpa (Grand Valley State University)

Jason Miller (Michigan State University)

Rod Thomas (University of Arkansas)

Matt Waller (University of Arkansas)

ISA SPECIAL SESSION | "The Future of Energy"

4:15pm—5:00pm

Samberg Conference Center, 7th Floor

ISA SPECIAL SESSION | "The Future of Biotechnology"

5:00pm—6:00pm

Samberg Conference Center, 7th Floor

COFFEE/SNACKS

6:00pm—6:15pm

Samberg Conference Center, 7th Floor

EVENING PLENARY | "The New Lunar Society" Book Talk & Fireside Chat

6:15pm—7:00pm

Samberg Conference Center, 7th Floor

WELCOME RECEPTION

7:00pm—9:30pm

- Special Welcome - Sally Kornbluth, MIT President

- Recognition ceremony honoring Richard Lester

Samberg Conference Center, 7th Floor



Wednesday, June 4
4:15—5:00 pm

The Future of Energy

Panelists' Bios

The global energy system is changing rapidly, and opportunities for further change abound. But innovators must surmount many barriers to commercialize and diffuse new and improved products and services. Energy affordability and reliability are paramount concerns, incumbents may block progress, the system is extremely complex, and sustainability is multi-faceted and often difficult to assess. This panel will explore the barriers, risks, and opportunities posed by the energy transition with an eye toward managerial, institutional, and policy reforms that accelerate innovation. The goals may, among other things, include unlocking venture, growth, and project finance, facilitating collaboration across organizational and national boundaries, and supporting first-of-a-kind projects and early adopters.



Moderator: David Hart - David M. Hart is a Professor of Public Policy at the Schar School of Policy and Government at George Mason University, specializing in science and technology policy. He also serves as a Senior Fellow for Climate and Energy at the Council on Foreign Relations. His research focuses on accelerating clean energy and climate-tech innovation, and he has contributed to major federal energy policy initiatives. Hart previously served as Assistant Director for Innovation Policy at the White House Office of Science and Technology Policy and has led efforts in industrial decarbonization and international R&D cooperation. He holds a Ph.D. in political science from MIT and a BA from Wesleyan University.



Katie Rae - Katie Rae is the CEO & Managing Partner of Engine Ventures, where she leads investments in breakthrough Tough Tech companies. She serves on the boards of several portfolio companies, including Boston Metal, Commonwealth Fusion Systems, Form Energy, and Sublime Systems. With over 10 years of experience as an investor and 25 years as a tech executive, she has helped shape Boston's innovation ecosystem. Previously, she was Managing Director of Techstars Boston and co-founded Project 11 Ventures. Rae has invested in nearly 100 companies, including PillPack (acquired by Amazon for \$1 billion). She holds an MBA from Yale and a BA in Biology from Oberlin College.



Vanessa Chan - Vanessa Chan is the Vice Dean of Innovation and Entrepreneurship at Penn Engineering and a Jonathan and Linda Brassington Practice Professor in Materials Science and Engineering. She is an accomplished entrepreneur, angel investor, and educator, known for her expertise at the intersection of technology and business. Under President Biden, she served as the Chief Commercialization Officer and Director of the Office of Technology Transitions at the U.S. Department of Energy, where she played a key role in advancing clean energy technologies. Prior to joining Penn Engineering, she was a partner at McKinsey & Company, co-leading its innovation practice, and later founded re.design, a company focused on reinventing consumer products. Chan holds a Ph.D. from MIT and a B.S.E. from the University of Pennsylvania, both in Materials Science and Engineering.



Daniel Goldman - Daniel Goldman is Co-Founder and Managing Director of Clean Energy Ventures. He has more than 25 years of energy industry experience in strategy, corporate and project finance, and project development, as well as private equity/asset investment and early-stage venture investing. Over the course of his career, Mr. Goldman's experience has spanned the upstream, mid-stream and downstream oil, gas, coal and power generation sectors of the industry, and since 2000 has included an extensive focus on clean energy asset development and finance, energy efficiency technology development, as well as venture and project investments, both domestically and internationally.

Wednesday, June 4
5:00—6:00 pm

Panelists' Bios

The Future of Biotechnology

Biotechnology holds great potential for transforming industries yet faces critical challenges as it grows in a shifting global landscape. From the promise of new therapies and bio-based products, to the challenges of manufacturing scale-up, financing innovations, and navigating an increasingly fragmented trade landscape, this fireside chat explores what we can see ahead and where policy, technologies, and strategy need to advance. With perspectives from a global pharmaceutical leader and a platform manufacturing innovator, the session will consider what it will take to maintain competitiveness, build resilient infrastructure, and realize the societal potential of biotechnology.



Moderator: Chris Love - J. Christopher Love is the Raymond A. (1921) and Helen E. St. Laurent Professor of Chemical Engineering at MIT. His research focuses on micro/nanofabrication, surface chemistries, cellular immunology, infectious diseases, immunotherapy, vaccines, and clinical diagnostics. Love earned his Ph.D. from Harvard University and his B.S. from the University of Virginia. He has received numerous honors, including the Camille Dreyfus Teacher-Scholar Award and Popular Science's "Brilliant 10" recognition. His work aims to advance biomedical technologies and improve treatments for human disease.



Rahul Singhvi - He is the Chief Executive Officer of National Resilience, Inc., a biomanufacturing company he co-founded in 2020. Before Resilience, he was an Operating Partner at Flagship Pioneering, where he helped launch and operate companies from Flagship Labs. Singhvi previously served as Chief Operating Officer of Takeda's vaccine business unit and was President and CEO of Novavax, Inc. He began his career at Merck & Co. in R&D and manufacturing. Singhvi holds a Ph.D. and M.S. in Chemical Engineering from MIT, a B.Tech. from IIT Kanpur, and an MBA from the Wharton School at the University of Pennsylvania, where he graduated as a Palmer Scholar. He serves on the Board of Trustees of Keck Graduate Institute and the Board of Directors for Codexis and Garuda Therapeutics.



Christophe Weber - Christophe Weber is the President, CEO, and Representative Director of Takeda Pharmaceutical Company Ltd. He joined Takeda in April 2014 as Chief Operating Officer, became President and Representative Director in June 2014, and was appointed CEO in April 2015. Under his leadership, Takeda has expanded globally and transformed its R&D strategy while fostering a diverse and inclusive work environment. Before Takeda, Weber spent 20 years at GlaxoSmithKline in senior leadership roles across Europe, Asia, and the United States. He holds a doctorate in pharmacy and pharmacokinetics, along with master's degrees in pharmaceutical marketing, accounting, and finance from the University of Lyon, France.

Wednesday, June 4
6:15—7:00 pm

Panelists' Bios

Evening Plenary | "The New Lunar Society" Book Talk & Fireside Chat

Climate change, global disruption, and labor scarcity are forcing us to rethink the underlying principles of industrial society. In *The New Lunar Society*, David Mindell envisions this new industrialism from the fundamentals, drawing on the eighteenth century when first principles were formed at the founding of the Industrial Revolution. While outlining the new industrialism, he tells the story of the Lunar Society, a group of engineers, scientists, and industrialists who came together to apply the principles of the Enlightenment to industrial processes. Those principles were collaboration, the marriage of practical and scientific knowledge, and the belief that the world could progress through making things.



David Mindell - David A. Mindell is the Frances and David Dibner Professor of the History of Engineering and Manufacturing at MIT and a Professor of Aeronautics and Astronautics. He has spent over three decades researching the relationship between humans and machines, particularly in space exploration, robotics, and autonomous systems. Mindell is the author of several books, including *Our Robots, Ourselves* and *Digital Apollo*, which examine human-machine collaboration in technology and spaceflight. He is also the co-founder of Humatics Corporation, a company focused on precision navigation and robotics, and a partner at Unless, an initiative revitalizing U.S. industry around decarbonization and equitable work.



Richard Lester - Richard K. Lester is the MIT Japan Steel Industry Professor and was Vice Provost for International Activities between 2015-2024. He previously served as Chair of the Department of Nuclear Science and Engineering from 2009 to 2015 and is the founding director of the MIT Industrial Performance Center. Professor Lester's research over the years has been concerned with innovation strategy and management, with a frequent focus on the energy and manufacturing sectors. He is widely recognized for his work on national and regional innovation systems and has advised governments and industry groups worldwide. He holds a Ph.D. in nuclear engineering from MIT and a chemical engineering degree from Imperial College London.

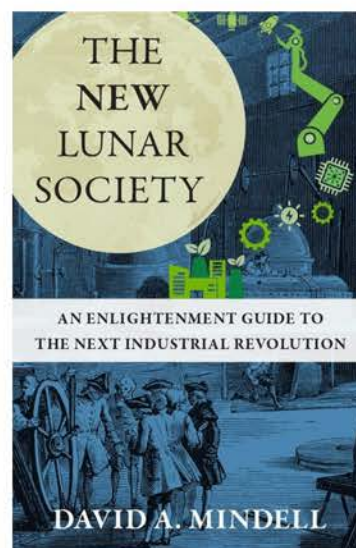

Wednesday, June 4
7:00—9:30 pm

MIT President

Welcome Reception Honoring Richard Lester



Sally Kornbluth - Sally Kornbluth became MIT's 18th president on January 1, 2023. A cell biologist and former Duke University provost (2014-2022), she earned recognition as a brilliant administrator and advocate for faculty excellence and student wellbeing. At MIT, she has championed freedom of expression, intensified AI safety efforts, and launched the Climate Project to address global warming.

Born in Fair Lawn, New Jersey, Kornbluth earned her BA in political science from Williams College (1982), then pivoted to biology with a BA in genetics from Cambridge University (1984) and PhD in molecular oncology from Rockefeller University (1989). After postdoctoral training at UC San Diego, she joined Duke in 1994, rising from assistant to full professor by 2005. She served as vice dean for basic science at Duke School of Medicine before becoming provost, where she led efforts to develop a pipeline of faculty from underrepresented groups and created an Office for Faculty Advancement that led a 30% increase in the number of Black faculty from 2018 to 2022.

Her research focuses on cellular signals controlling division and programmed cell death (apoptosis), key to understanding cancer and degenerative disorders. She has published extensively on how cancer cells evade apoptosis, how metabolism regulates cell death, and apoptosis's role in female fertility. She is a member of the National Academy of Medicine, National Academy of Inventors, and American Academy of Arts and Sciences, receiving Duke's Basic Science Research Mentoring Award (2012) and Distinguished Faculty Award (2013).

She and her husband Daniel Lew, an MIT biology professor, have two grown children.

"Today, the problems before us – the problems of human society, and of its only planet so far – require that we harness our curiosity in exceptionally productive ways. The people of MIT have always wanted to know how things work, and how we can be part of big solutions. Now, it's imperative that we know – and that we help lead the world to action."

**Sally Kornbluth
MIT President**



Conference Program: Thursday, June 5

ISA Breakfast

7:00am—8:00am

Samberg Conference Center, 7th Floor

ISA RESEARCH SESSIONS

8:00am—9:00am

See Session 3 schedule; includes 7 research streams

ISA SPECIAL SESSIONS - (select one) Samberg Conference Center, 6th Floor

9:15am—10:15am Track A: Comparative Industrial Policy

9:15am—10:15am Track B: New Organizational Structures for Manufacturing

COFFEE/SNACKS

10:15am—10:45am

Samberg Conference Center, 7th Floor

ISA RESEARCH SESSIONS

10:45am—11:45am

See Session 4 schedule; includes 7 research streams

ISA BUSINESS MEETING LUNCHEON

12:00pm—1:00pm

Samberg Conference Center, 7th Floor

ISA RESEARCH SESSIONS

1:15pm—2:15pm

See Session 5 schedule; includes 7 research streams

ISA RESEARCH SESSIONS

2:30pm—3:30pm

See Session 6 schedule; includes 7 research streams

COFFEE/NETWORKING

3:30pm—3:50pm

Samberg Conference Center, 7th Floor

ISA RESEARCH SESSIONS

3:50pm—4:50pm

See Session 7 schedule; includes 5 research streams

ISA PLENARY | “Industry Evolution”

5:00pm—6:00pm

Samberg Conference Center, 7th Floor

ISA ANNUAL CONFERENCE RECEPTION

6:00pm—7:30pm

Samberg Conference Center, 7th Floor



BREAKFAST & REGISTRATION

7:00am—8:00am

Samberg Conference Center, 7th Floor

ISA RESEARCH SESSION 3

8:00am—9:00am

Tang Center (E51, 3rd Floor)

Sloan (E62, 2nd Floor)

PP8. Intellectual Property and Innovation

E51-315

Chair: Renato Garcia (University of Campinas)

Evaluating Public Support for R&D expenditures: A Dose-Response Analysis of a SME R&D Grants Program in Brazil

Renato Garcia (University of Campinas)

Veneziano Araujo (Federal University of São Paulo)

Sarah Ribeiro Ferreira (University of Campinas)

Innovation intermediaries in the digital transformation process. A comparative case study of Research and Technology Organisations in the US and the UK

Guendalina Anzolin (University of Cambridge)

Eoin O'Sullivan (Institute for Manufacturing, University of Cambridge)

From Best Practice to Best Fit: Knowledge Intermediaries and Selective Practice Adoption Under Resource Scarcity

Canberk Ucel (ESSEC Business School/INSEAD)

Natalie Carlson (The Wharton School, University of Pennsylvania)

IE11. Product & Technology Strategies

E51-372

Chair: Dafna Bearson (Harvard Business School)

Transferability MATTRs: Towards Understanding Antecedents of Strategic Licensing

Dafna Bearson (Harvard Business School)

Maria Roche (Harvard Business School)

Innovating on a Legal Minefield: How Litigation Risks Shape IT Firms' Patent Strategies

Aija Leiponen (Cornell University)

Yifan Liu (Tsinghua University)

Mingtao Xu (Tsinghua University)

Zhe Xue (Uber Technologies)

Optimal Distinctiveness Decomposed: Balancing Functionality and Aesthetics in Products

Bryn Choi (Gies College of Business, University of Illinois at Urbana-Champaign)

Olga Khessina (Gies College of Business, University of Illinois at Urbana-Champaign)

Samira Reis (Universidad Carlos III de Madrid)

Strategic Responses to Rival Advancements: R&D Project Decisions and Resource Redeployment

Christine Choi (University of North Carolina, Chapel Hill)

Sohyun Park (Stevens Institute of Technology)

Min Jung Kim (Korea University)



IE14. Timing of Startup Activity

E51-376

Chair: Jacqueline Lane (Harvard Business School)

Fear of Missing Out: The Impact of Human and Social Capital on The Timing of Start-Up Exit Via Acquisition

Jennifer Woolley (Santa Clara University)

Adele Xing (Santa Clara University)

How Do Investors Shape Startups' Response to New Market Opportunities?

Sukhun Kang (UC Santa Barbara)

Sarath Balachandran (London Business School)

Sungyong Chang (Cornell University)

Greenlighting Innovative Projects: How Evaluation Format Shapes the Perceived Feasibility of Early-Stage Ideas

Jacqueline Lane (Harvard Business School)

Simon Friis (Harvard Business School)

Tianxi Cai (Harvard T.H. Chan School of Public Health)

Griffin Weber (Harvard Medical School)

Eva Guinan (Harvard Medical School and Dana Farber Cancer Institute)

GO2. Business and Corporate Strategy

E51-395

Chair: Arkadiy Sakhartov (University of Illinois at Urbana-Champaign)

Organizational Political Slant: Unveiling Political Bias in Ordinary Corporate Communications

Tommy Pan Fang (Rice University)

Yusaku Takeda (University of Illinois at Urbana-Champaign)

Resource Redeployment in Multi-Business Firms: Centralized Or Decentralized?

Arkadiy Sakhartov (University of Illinois at Urbana-Champaign)

Constance Helfat (Dartmouth College)

The Perils of a Soft Start: Initial Conditions, Early Strategy Selection, and Small Firm Performance

Christopher Eaglin (Fuqua School of Business, Duke University)

Private Equity, Corporate Acquirers, and Product Innovation in Technology Acquisitions

Sathyanarayan Vijayakumar (The Wharton School at the University of Pennsylvania)

OP1. AI, Digital Innovation, and Data Governance

E62-262

Chair: Timothy Sturgeon (Massachusetts Institute of Technology Industrial Performance Center)

AI Review Summary, Customer Ratings, and Performance Entrenchment

Wesley Koo (Johns Hopkins University)

Jingchuan Pu (University of Florida)

Nianqing Gao (Johns Hopkins University)

Investigating AI-driven Strategies for Multisolving in Container Port Terminals

Naoum Tsolakis (International Hellenic University)

Nitin Joglekar (Villanova University)

Massive Modular Ecosystems: a Framework for Understanding Complex Industries in the Digital Age

Timothy Sturgeon (Massachusetts Institute of Technology Industrial Performance Center)

Eric Thun (University of Oxford)

Daria Taglioni (World Bank Development Research Group)

Mark Dallas (U.S. Department of Commerce and Union College)



HC2. Design and Innovation in Healthcare Delivery

E62-221

Chair: Jenny Kuan (California State University Monterey Bay)

Design and Evaluation of a Life-Long Medical History System for Efficient Healthcare Data Management
Forhad Hossain (Sophia University)

Theorists as Strategists: Ideas on Fixing US Healthcare
Jenny Kuan (California State University Monterey Bay)
Gwendolyn Lee (University of Florida)

Evaluating Inclusive Innovation in the Development and Application of Smart Technologies in Elderly Healthcare

Natasha Tiangco (National Yang Ming Chiao Tung University)
Wen-Hsin Chi (National Yang Ming Chiao Tung University)
Shih-Hsin Chen (National Yang Ming Chiao Tung University)

Real Prospects for AI-Driven Advances in Healthcare: Lessons from Industrial Relations

Ayaj Rana (Cornell University)
Adam Seth Litwin (Cornell University)
Deepa Kylasam Iyer (Cornell University)

EN3 Decarbonization in Industry

E51-361

Chair: Tyler Hansen (Dartmouth College)

Twin transition and industrial relations in the German steel industry

Alexander Bendel (University of Duisburg-Essen)
Thomas Haipeter (University of Duisburg-Essen)

Institutional learning in the energy transition: the case of U.S. offshore wind

Tyler Hansen (Dartmouth College)
Stephanie Lenhart (Boise State University)
Aidan Muller (Dartmouth College)
Elizabeth J. Wilson (Dartmouth College)

The Why, How, and Where of Industrial Decarbonization: Preliminary Findings from the 2023 Annual Business Survey

Zheng Tian (Pennsylvania State University)
Minsu Kim (Pennsylvania State University)
Luyi Han (Pennsylvania State University)
Stephan Goetz (Pennsylvania State University)

Varieties of Demand, Technological Pathways, and Industrial Innovation Systems in Sustainability Transitions

Keno Haverkamp (Institute for Manufacturing, University of Cambridge)
Eoin O'Sullivan (Institute for Manufacturing, University of Cambridge)

ISA SPECIAL SESSIONS - (select one) Samberg Conference Center, 6th Floor

9:15am—10:15am Track A: Comparative Industrial Policy

9:15am—10:15am Track B: New Organizational Structures for Manufacturing



Thursday, June 5
9:15—10:15 am

Panelists' Bios

Special Session | Comparative Industrial Policy

Across the globe, and particularly in the U.S., interest is burgeoning in policies to promote national competitiveness in key traded industries. With the widespread adoption of neo-liberal principles (e.g., the Washington Consensus), such policies were deemed inappropriate for practice and research until recently. As a result, industry studies scholars now have the opportunity and challenge of shaping principles of approach for a new field. To facilitate that effort, panel members will compare and contrast their respective conceptions of the desirable ends and means of national industrial policy—including, in this particular political moment, the role of tariffs.



Moderator: Andrew Reamer - Andrew Reamer is a Research Professor at the George Washington Institute of Public Policy, specializing in U.S. economic competitiveness, innovation policy, and workforce development. He has served on multiple federal advisory committees, including the National Advisory Council on Innovation and Entrepreneurship and the Workforce Information Advisory Council. Reamer holds a Ph.D. in Economic Development and Public Policy and a Master in City Planning from MIT, as well as a B.S. in Economics from the Wharton School at the University of Pennsylvania.



Elisabeth Reynolds - Elisabeth Reynolds is Professor of the Practice in the MIT Department of Urban Studies and Planning. She was Special Assistant to the President of the U.S. for Manufacturing and Economic Development at the National Economic Council (2021-2022) where she helped lead the Administration's work on national manufacturing strategy, supply chain resilience and industrial strategy. Before working at the NEC, Reynolds was executive director of the MIT Industrial Performance Center (2010-2021) and also co-led the MIT Task Force on the Work of the Future (2018-2021).

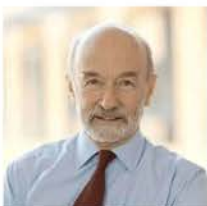

Sir Mike Gregory - Mike Gregory is the founder of the Institute for Manufacturing at the University of Cambridge, where he served as Head of the Manufacturing and Management Division until 2015. His research spans manufacturing strategy, technology management, and policy, with strong industry and government ties. He has held leadership roles at the Cambridge MIT Institute, UC Berkeley, and the Institute for Sustainability Leadership. Gregory also serves on key advisory boards, including the High Value Manufacturing Catapult. He is a Fellow of Churchill College and the Royal Academy of Engineering.



Bill Janeway - William H. Janeway is a Senior Advisor and Managing Director at Warburg Pincus, specializing in IT investments. He is an Ambassador for Cambridge Judge Business School and a Visiting Lecturer at Cambridge and Princeton. Janeway serves on advisory boards, including the Cambridge Endowment for Research in Finance. He authored *Doing Capitalism in the Innovation Economy* and holds a Ph.D. from Cambridge.



Chris Griswold - Chris Griswold is the Policy Director at American Compass, specializing in economic policy and industrial strategy. He has served as a CFR-Hitachi International Affairs Fellow and was a Senior Advisor on the U.S. Senate Committee on Small Business and Entrepreneurship. Griswold holds a Master of Divinity from Princeton Theological Seminary and a BA from Wheaton College.



Jason Jackson - Jason Jackson is an Associate Professor of Political Economy and Urban Planning at MIT. He leads the Political Economy Lab, studying economic nationalism, industrial development, and digital platforms. Jackson holds a Ph.D. from MIT, an AB from Princeton, an MSc from SOAS, and an MPA from Harvard Kennedy School.

Thursday, June 5
9:15—10:15 am

Panelists' Bios

Special Session | New Organizational Structures for Manufacturing

There is a growing consensus among public officials and the private sector that the United States needs more manufacturing. Since 2021, there has been a surge in public and private investment in new factories, along with sustained growth in hiring. Will new investment in manufacturing lead to new models of financing and corporate governance for manufacturing firms? Revitalizing U.S. industrial capacity is a long-term project. However, current financial models are focused on short-term returns. For decades, public markets favored asset-light businesses that can meet quarterly targets. Private equity and venture capital funds are often subject to time pressures as well. This panel brings together experts and practitioners to discuss the role that capital plays in shaping manufacturing – and creative ways to support the long-term growth of the industrial economy.



Ben Armstrong - Ben Armstrong is the Executive Director of MIT's Industrial Performance Center and a Research Scientist, co-leading the Work of the Future initiative. His research examines how workers, firms, and regions adapt to technological change, with projects focused on U.S. manufacturing workforce development and regional economic strategies.



Suzanne Berger - Suzanne Berger is an Institute Professor at MIT's Department of Political Science, specializing in political economy, globalization, and industrial policy. She has led major research initiatives on innovation and production, including MIT's Work of the Future Task Force. Berger has authored influential books on global manufacturing and economic competitiveness and has advised governments and industry leaders on policy strategies.



Miles Arnone - Miles Arnone is the CEO of Re:Build Manufacturing, dedicated to revitalizing U.S. manufacturing through technology, operational excellence, and strategic acquisitions. He has extensive experience in evaluating, acquiring, and turning around technology-driven businesses, having worked across North America, Western Europe, China, and Taiwan. After leading several machine tool companies and overseeing dozens of firms at American Capital, he co-founded Cannon Capital before launching Re:Build Manufacturing in 2020. He holds undergraduate and MS degrees in engineering and management from MIT.



Steve Cook - Steve Cook is a Managing Director at LFM Capital, bringing extensive experience in private equity and industrial operations. He has a strong background in evaluating, acquiring, and managing manufacturing businesses, with a focus on operational improvement and strategic growth. Before joining LFM Capital, he held leadership roles in various industrial companies, driving efficiency and expansion. Steve holds an engineering degree and has played a key role in supporting middle-market manufacturing firms.



Thursday, June 5

COFFEE/SNACKS

10:15am–10:45am

Samberg Conference Center, 7th Floor

ISA RESEARCH SESSION 4

10:45am–11:45am

Tang Center (E51, 3rd Floor)

Sloan (E62, 2nd Floor)

IE5. Geography & Knowledge Flows

E51-315

Chair: Keith Pennington (University of Connecticut)

Is Convenience the Enemy of Innovation? The Zika Virus's Gendered Effect on Inventor Collaborations
Sohyun Park (Stevens Institute of Technology)
Keith Pennington (University of Connecticut)

Knowledge Spillover Insights from a Micro-Scale Counterfactual Approach to Technology Competition in the Surgical Device Industry
Keith Pennington (University of Connecticut)

Catalysts of Innovation: The Role of Multi-Location Firms in Local Knowledge Development
Shuqi Sun (Arizona State University)
Maryann Feldman (Arizona State University)

How city patenting fosters entrepreneurship? A nexus between local firm ventures and short cycle technologies
I Kim Wang (Suffolk University)
Chan Yuan Wong (National Tsing Hua University)

GO3. Competitive Positioning and Analysis

E51-372

Chair: Sruthi Thatchenkery (Vanderbilt University)

Embedding Products with Meaning: Social and Artistic Value Infusion in Cultural Industries
Bryn Choi (Gies College of Business, University of Illinois at Urbana-Champaign)
Olga Khessina (Gies College of Business, University of Illinois at Urbana-Champaign)
Samira Reis (Universidad Carlos III de Madrid)

Great minds think alike, right? Producer and consumer (mis)alignment in perceptions of product distinctiveness
Hyeonsuh Lee (West Virginia University)
Ryan Angus (West Virginia University)
Matthew A. Barlow (University of Nebraska-Lincoln)
J. Cameron Verhaal (Tulane University)

Humanwashing and AIEMs: Is my AI-enabled machine really my friend?
Amy Gresock (University of Pittsburgh, Bradford)
Kira Leck (University of Pittsburgh, Bradford)

Out of Left Field: How Experiential Variety and Depth on the Top Management Team Enables Attention to Emerging Competitors
Sruthi Thatchenkery (Vanderbilt University)



HC3. Healthcare Needs Treatment - Current Issues in Healthcare Delivery **E51-376**

Chair: Victoria (Shu) Zhang (Northeastern University)

Place-based care and childhood obesity

John Lowrey (Northeastern University)

Ben Grant (Clemson University)

Vishal Ahuja (Southern Methodist University)

Ihuoma Eneli (The University of Colorado Anschutz Medical Campus)

Inequity in (Process of) Care: Evidence from Medicare Reform

Subhankar Saha (Ahmedabad University)

Sriram Thirumalai (Texas Christian University)

Sarang Sunder (Indiana University)

Learning the Wrong Lessons: Changes in Physician Practice After Allegations of Malpractice

Victoria (Shu) Zhang (Northeastern University)

Patrick Bergemann (University of California Irvine)

PP2. Government Regulation and Innovation Policy

E51-376

Chair: Angela Ryu (University of Southern California)

How Ownership Affects Milestone-based Product Development: Evidence from a FCC Rule Change

Ankur Chavda (HEC Paris)

Lobbying to Kill [a] Bill: Product Market Competition and Negative Lobbying

Angela Ryu (University of Southern California)

Crafting Policy: Gaining Influence Through Strategic Compromises and Enduring Coalitions in Corporate Political Activity

Eppa Rixey (Massachusetts Institute of Technology)

Regulation and new industries: Canada's struggle to develop a legal recreational cannabis market

Arlinda Sherifi (Salem State University)

John McArdle (Salem State University)

Alice de Koning (University of Calgary)

PP9. Designing Innovation-Friendly Policies

E62-221

Chair: Pelin Bicen (Suffolk University)

Why do founders rush in? Government promotion, individual talent, and entrepreneurship performance in China

Liaodan Zhang (Zhejiang University)

Song Wang (Zhejiang University)

Yanbo Wang (University of Hong Kong)

The Offline Basis of Rural E-Commerce Success

Jane Jiang (The Ohio State University)

Qiyao Zhou (Oklahoma State University)

Ziyang Chen (Nanjing University)

Institutional Evolution in Geographical Indication Systems: State-Producer Dynamics in Türkiye's Olive Oil Sector

Pelin Bicen (Suffolk University)



LM1. AI and the Transformation of Work

E62-262

Chair: Avner Ben-Ner (University of Minnesota)

Corporate governance, ownership, and the introduction of new technology

FNU Adrianto (University of Minnesota)
Avner Ben-Ner (University of Minnesota)

Machine Predictions and Causal Explanations: Evidence from a Field Experiment

Hyunjin Kim (INSEAD)
Xi Kang (Vanderbilt University)

Eliciting Domain Expertise in the Absence of Formal Authority: The Case of AI
Developers and Domain Experts in a Large Firm

Arvind Karunakaran (Stanford University)
Luca Vendraminielli (Stanford University)
Devesh Narayanan (Stanford University)

EN4. Energy Transition Policy & Governance

E51-361

Chair: Anthony Cheng (Carnegie Mellon University)

Economic and environmental impacts of U.S. place-based policies promote EV
battery supply chain security

Anthony Cheng (Carnegie Mellon University)
Valerie Karplus (Carnegie Mellon University)
Erica Fuchs (Carnegie Mellon University)
Jeremy Michalek (Carnegie Mellon University)

The Political Economy of the Energy Transition: Cost, Coordination, Profit

Jonas Meckling (University of California, Berkeley)
Gunnar Trumbull (Harvard Business School)

Understanding the Stop-and-Go Cycle of Fuel Cell Development: The Role of the U.S. as a
National Lag Market

I Kim Wang (Suffolk University)
Mark Lehrer (Suffolk University)

Leading from Below: Turning Greater Sudbury into an export hub of mining innovation
and sustained prosperity

Dan Breznitz (University of Toronto)
Scott McKnight (University of Toronto)
Marte Vroom (University of Toronto)

ISA BUSINESS MEETING LUNCHEON

12:00pm—1:00pm

Samberg Conference Center, 7th Floor



ISA RESEARCH SESSION 5

1:15pm—2:15pm
Tang Center (E51, 3rd Floor)
Sloan (E62, 2nd Floor)

PP10. Inclusive Innovation and Regional Strategies

E51-315

Chair: Jenny Kuan (California State University Monterey Bay)

The Emergence of Cooperative Strategy through Collective Action in the Fabless Semiconductor Industry
Jenny Kuan (California State University Monterey Bay)
Joel West (Keck Graduate Institute)

Strategic Coupling and the CHIPS and Science Act: An Inter-Organizational Network Ethnography
Katreen Boustani (Syracuse University School of Information Studies)

The impact of EV production on automotive foreign direct investments and production: what has changed and what are the implications for countries with (and without) automotive-related capabilities?
Guendalina Anzolin (Institute for Manufacturing, University of Cambridge)
Eoin O'Sullivan (Institute for Manufacturing, University of Cambridge)
Keno Haverkamp (Institute for Manufacturing, University of Cambridge)

Assessing the Economic and Social Impact of Loss of Access to Critical Microelectronics
Alex Newkirk (Carnegie Mellon University)
Erica Fuchs (Carnegie Mellon University)
Constantine Samaras (Carnegie Mellon University)
Granger Morgan (Carnegie Mellon University)

GO4. Entrepreneurial Process and Industry Evolution

E51-372

Chair: Carmen Weigelt (Tulane University)

Follow the money, map the impact: Egocentric Network of R&D funders Reshaping Innovation trajectories
Martin Ho (University of Cambridge)
Henry CW Price (Imperial College London)
Tim S Evans (Imperial College London)
Eoin O'Sullivan (University of Cambridge)

Keeping it Real in the Death Zone: Individual Responses to Organizational Identity Threats, and the Use of Contested Practices in Mount Everest Climbing Expeditions, 1921-2019.
Carmen Weigelt (Tulane University)
Cameron Verhaal (Tulane University)

The transformation of engineering consulting, a professional service industry, from professional partnerships into managed professional businesses
Bruce Tether (Alliance Manchester Business School, University of Manchester)



OP3. Improving outcomes in global pharmaceutical supply chains

E51-376

Chair: Hanu Tyagi (University of Illinois)

Data Privacy and Innovation: The Case of GDPR

Sukhun Kang (UC Santa Barbara)
Sarath Balachandran (London Business School)
Sungyong Chang (Cornell University)

Surprise! The Relative Effectiveness of Preannounced and Unannounced Inspections in the Pharmaceutical Industry

Zachary Wright (Brigham Young University Marriott School of Business)
John Gray (Fisher College of Business, Ohio State University)
In Joon Noh (Korea University)
George Ball (Kelley School of Business, Indiana University)

When life gives you lemons: Spillovers between pharmaceutical recalls and shortage

Hanu Tyagi (University of Illinois)
Rachna Shah (University of Minnesota)
Junghee Lee (University of Notre Dame)

Identifying the Global Sources of Antibiotics for the US Market to Enhance Supply Chain Resiliency

Mariana Socal (Johns Hopkins Bloomberg School of Public Health)
Yunxiang Sun (Johns Hopkins Bloomberg School of Public Health)
Jeromie Ballreich (Johns Hopkins Bloomberg School of Public Health)
Tinglong Dai (Johns Hopkins Carey Business School)
Maqbool Dada (Johns Hopkins Carey Business School)

EN5. Market Dynamics & Disclosure

E51-395

Chair: Aurora Genin (Indiana University)

Carbon Disclosure, Market Demand, and Climate Innovation in the Global Supply Chain

Aurora Genin (Indiana University)
Juan Bu (Indiana University)
Xiaoqiong Wang (Jacksonville State University)
Jing Yu (University of Sydney)

Price Meets Power: A Study of Electric Vehicle Sales Performance and Market Evolution

Russell Seidle (Suffolk University - Sawyer Business School)
Kim Wang (Suffolk University - Sawyer Business School)
Ken-Zen Chen (Institution of Education, National Yang Ming Chiao Tung University)

Shiny, Transparent, and Opaque: Using Narrative and Verifiable Disclosure to Manipulate Perceptions of Environmental Activities

Guangshun Chen (Rice University)
Diana Jue-Rajasingh (Rice University)



HC4. Healthcare Advancements and Biopharma Evolution

E62-221

Chair: Jisoo Park (Clark University)

How Employing Contractors Affects Organizational Learning: Evidence from U.S. Hospitals
Jisoo Park (Clark University)

The Mediating Role of Smart Healthcare Living Labs in Knowledge Transfer and Technological Commercialization

Shih-Hsin Chen (National Yang Ming Chiao Tung University)
Yi-Min Ruby Wang (National Yang Ming Chiao Tung University)
Wen-Hsin Chi (National Yang Ming Chiao Tung University)
Hung-Chi Chang (National Yang Ming Chiao Tung University)

Founder-CEO and attention breadth: Empirical evidence from clinical trial failures
Tang Wang (University of South Florida)

The Development Trajectory of Taiwan's CDMO Industry
Ching-Yan Wu (National Tsing Hua University)
Meng-Hsun Kuo (National Tsing Hua University)

PP7. Learning from Emerging Economies

E62-262

Chair: Viktória Döme (Institute for Manufacturing, University of Cambridge)

Industrial Policy for Competitiveness in the Energy Transition
Ketan Ahuja (Harvard Kennedy School), Ricardo
Hausmann (Harvard Kennedy School)

Export competition, cross-sector coalition, and the emergence of superstar exporters in the target industry --- the case of solar industry in China
Christina Pan (Cornell University)

Global Value Chain Shifts in the Semiconductor Industry: R&D and Manufacturing FDI investments
Viktória Döme (Institute for Manufacturing, University of Cambridge)
Guendalina Anzolin (Institute for Manufacturing, University of Cambridge)
Eoin O'Sullivan (Institute for Manufacturing, University of Cambridge)

Industrial policies for establishing a semiconductor production base: A comparative study of India and East Asia
Abhishek Krishnan (Indian Institute of Technology Madras)
Deleep Nair (Indian Institute of Technology Madras)
Subash S (Indian Institute of Technology Madras)



IE7. Impact of Geography on Innovation

E51-361

Chair: Roxanne Jaffe (Vanderbilt University)

Are Female Inventors Geographically Constrained? Gender Differences in Team Collocation

Mercedes Delgado (CBS)

Luca Gius (MIT Sloan)

Re-thinking the value of local explicit knowledge in the contemporary context: time and geography

Tan Tran (ICD Business School)

David B. Audretsch (School of Public and Environmental Affairs, Indiana University Bloomington)

Maksim Belitski (Henley Business School, University of Reading)

Quoc Tran - Nam (Ho Chi Minh University of Banking)

The Effect of Startup Revenue Pressure on Firm Geographical Expansion: Evidence from the Micro-Mobility Industry

Roxanne Jaffe (Vanderbilt University)

Innovate First and Regulate Later? Study On Geographical Heterogeneity in Autonomous Vehicles Legislation in The U.S.

Izzet Darendeli (California State University East Bay)

ISA RESEARCH SESSION 6

2:30pm—3:30pm

Tang Center (E51, 3rd Floor)

Sloan (E62, 2nd Floor)

EN6. Renewable Energy Infrastructure & Integration

E51-315

Chair: John Helveston (George Washington University)

Measuring Consumer Willingness to Enroll in Battery Electric Vehicle Smart Charging Programs

John Helveston (George Washington University)

Pingfan Hu (George Washington University)

Brian Tarroja (University of California, Irvine)

Eric Hittinger (RIT)

Alan Jenn (University of California, Davis)

Demand Regimes, Innovation Dynamics, and Industrial Leadership: A Comparative Analysis of Wind Turbine Manufacturers in Europe

Keno Haverkamp (Institute for Manufacturing, University of Cambridge)

Antonio Andreoni (Centre for Sustainable Structural Transformation, SOAS University of London)

Residential Battery Storage - Reshaping the Way We Do Electricity

I Kim Wang (Suffolk University)

Chan Yuan Wong (National Tsing Hua University)

Assessing the Impact of Intermittent Resources on Power Price Volatility and Grid Stability

Andrew Shi (Dartmouth College)



IE6. Harnessing AI for Innovation & Evaluation

E51-372

Chair: Luca Gius (MIT Sloan)

Make, then Buy? Occupational Repositioning, Technology Bundling, and the Processes of AI Sourcing in a Large Firm

Arvind Karunakaran (Stanford University)
Luca Vendraminielli (Stanford University)
Devesh Narayanan (Stanford University)

Commercializing Contrarian Ideas: Evidence From AI Contests
Luca Gius (MIT Sloan)

The Narrative AI Advantage? A Field Experiment on Generative AI-Augmented Evaluations of Early-Stage Innovations

Jacqueline Lane (Harvard Business School)
Leonard Boussieux (University of Washington, Foster School of Business)
Charles Ayoubi (ESSEC Business School)
Rebecca Spens (MIT Solve)
Pooja Wagh (MIT Solve)

AI-Assisted Software Development: Modeling Strategic Tradeoffs in Productivity and Sustainability
Edward Anderson (University of Texas)
Geoffrey Parker (Dartmouth College)
Burcu Tan Erciyes (University of New Mexico)

OP5. New Lean and Automotive Production Systems – The Digital Transformation of the Automotive Industry

E51-376

Chair: Michael Rentschler (Hochschule Reutlingen)

Panel: New Lean and Automotive Production Systems
Michael Rentschler (Hochschule Reutlingen)

New Lean – The New Production System Paradigm
Roland Hall (Fraunhofer IPA)

GO5. Managing Risk and Uncertainty

E51-395

Chair: Dan Breznitz (University of Toronto)

Credit Reporting and the Origins of Surveillance Capitalism

Dan Breznitz (University of Toronto)
Scott McKnight (University of Toronto)
Marte Vroom (University of Toronto)

Real options reasoning, real options pricing, real option nothing: Twenty years after the real options debate

Arkadiy Sakhartov (University of Illinois at Urbana-Champaign)
Joseph Mahoney (University of Illinois at Urbana-Champaign)
Jeffrey Reuer (Purdue University)

The Formation of Initial Early-Stage Investing Syndicates: Investor or Entrepreneur Agency? Evidence From Prior Syndication Ties

Florence Honore (University of Wisconsin-Madison)
Jay Habegger (University of Maryland)

Studying enterprise risks as complex networks
Anan Sheth (Cal Poly - San Luis Obispo)



OP4. Resilience and Risk Management in Supply Chains

E62-262

Chair: Tonya Boone (William & Mary)

Long-term Dynamics of the Global Semiconductor Industry (1950s-2020s): Scaling, Specialization, and Global Value Chains

Takafumi Kurosawa (Kyoto University)

Managing Supply Chain Resilience and Cost Trade-Offs: A Study on the Alternative Protein Industry

Mariel Alem-Fonseca (University of Cambridge)

Helen Rogers (Technische Hochschule Nürnberg/Ohm University)

Naoum Tsolakis (University of Cambridge)

Mukesh Kumar (University of Cambridge)

Linking Firm Innovativeness To Supply Chain Resilience

Serhiy Ponomarov (The Citadel)

Fairness and Resilience in US Grocery Supply Chains: Lessons from the COVID-19 Pandemic

Tonya Boone (William & Mary)

Jing Liang (Chengdu University of Technology)

Yu Xia (William and Mary)

Ram Ganeshan (William and Mary)

HC5. The Regulatory Shaping of the Healthcare Industry

E62-221

Chair: Panos Markou (University of Virginia)

The Power of the Regulator: Regulatory Guidance and the Firms that Didn't Follow It During the Emergence of U.S. COVID-19 Diagnostics

Seojin Kim (Drexel University)

J.P. Eggers (New York University)

Mandatory Disclosure and Firms' R&D Decisions: Evidence from the FDA Amendments Act of 2007

Yongyi Lin (University of Maryland)

How Voting Protocols Shape Committee Discussions and Outcomes: New Product Evaluations at the FDA

Panos Markou (University of Virginia)

Tian Chan (Emory University)

LM2. Organizational Strategies and Worker Outcomes

E51-361

Chair: Andrew Weaver (University of Illinois Urbana-Champaign)

Rent-Sharing in Entrepreneurial Nonprofits

Abhisekh Ghosh Moulick (Baruch College CUNY)

The Emergence of Organizational Culture in New Ventures

Christopher Law (Texas A&M University)

Chris Bingham (University of North Carolina)

Chad Hartnell (Georgia State University)

Clause and Effect: Theory and Field Experimental Evidence on Noncompete Clauses

Bo Cowgill (Columbia University)

Brandon Freiberg (Columbia University)

Evan Starr (University of Maryland)



Thursday, June 5

COFFEE/NETWORKING

3:30pm–3:50pm

Samberg Conference Center, 7th Floor

ISA RESEARCH SESSION 7

3:50pm–4:50pm

Tang Center (E51, 3rd Floor)

Sloan (E62, 2nd Floor)

IE10. Platforms & Innovation Ecosystems

E51-395

Chair: Cameron Miller (Syracuse University)

AI for All? A study of the AI Innovation Ecosystem in the US

Raghavan V V (Indian Institute of Management Bangalore)

Vijay Venkataraman (Indian Institute of Management Bangalore)

Strategic Targeting and Unequal Global Adoption of Artificial Intelligence

Dafna Bearson (Harvard Business School)

Nataliya Wright (Columbia Business School)

How ecosystem technological structure shapes complementor's strategy: Evidence from the iOS ecosystem

Cameron Miller (Syracuse University)

Elena Plaksenkova (The Ohio State University)

Shiva Agarwal (University of Texas at Austin)

Willingness to PayPal: Network effects in the adoption of disruptive innovation

Yue Maggie Zhou (University of Michigan)

PP3. Author Meets Critic: Industrial Policy for the United States

E51-315

Chair: Andy Hira (Simon Fraser University)

Ian Fletcher (Coalition for a Prosperous America)

Jeff Ferry (Coalition for a Prosperous America)

Andy Hira (Simon Fraser University)

John Paul Helveston (George Washington University)

PP6. Innovation Policy Implementation

E51-372

Chair: Rosemarie Ziedonis (Boston University)

Small Business, Innovation, and the SBIR Program

Kyle Myers (Harvard Business School)

Evan Johnson (UNC-Chapel Hill)

Lauren Lanahan (University of Oregon)

Coordinated R&D Programs and the Creation of New Industries

Daniel P. Gross (Duke University)

Maria P. Roche (Harvard Business School)

Acquisition Market Thickness and R&D Investments: Evidence from National Security Restrictions

John McKeon (Boston University)

Zeyang Xue (Boston University)

Rosemarie Ziedonis (Boston University)



EN1. Sustainable Operations and Government Policy: A Systems Perspective **E51-376**

Chair: Edward Anderson (University of Texas, McCombs Business School)

Challenges for Sustainable Supply Chains & Operations Management Policy
Edward Anderson (University of Texas, McCombs Business School)

Government Policies for Resiliency in Critical Mineral Supply Chains
Burcu Tan Erciyas (University of New Mexico)
Sergey Naumov (Pennsylvania State University)
Edward Anderson (University of Texas, McCombs Business School)

AI Agent Enhanced Supply Chains - Emergent Regulatory and Transparency Risks and Opportunities
Nitin Joglekar (Villanova University)

Electrifying Away Climate Change: Interactions of Heat Pump Installation Capacity, Adoption, and Grid Load in Massachusetts
Alexander Kuptel (Massachusetts Institute of Technology)
John Sterman (Massachusetts Institute of Technology)

Sustainable Development Dynamics of Farmer Producer Organisations
Jagjit Singh Srai (University of Cambridge)
Edward Anderson (University of Texas, McCombs Business School)
Naoum Tsolakis (University of Cambridge)

PP11. Science Policy and Technology Governance

E62-262

Chair: Andrew Reamer (George Washington University)

The Origins of Today's Federal Economic Statistical Agencies in Supporting 19th Century Congressional Tariff-setting
Andrew Reamer (George Washington University)

Nearshoring in Mexico under Trump 2.0 is Not as Easy as It Seems
Gary Gereffi (Duke University)

A Smoother Transition from ICE to ACE The Need for a New Global Trade and Investment Regime for Autos and Auto Parts
David Hart (George Mason University)

ISA PLENARY | "Industry Evolution"

5:00pm—6:00pm

Samberg Conference Center, 7th Floor

ISA ANNUAL CONFERENCE RECEPTION

6:00pm—7:30pm

Samberg Conference Center, 7th Floor



Thursday, June 5
5:00—6:00 pm

Panelists' Bios

Plenary | Industry Evolution

How can the knowledge gained in studying one industry provide insights into other industries? This theme from the Call for Papers is the focus of this panel. Two of the panelists have spent much of the last six years developing and editing *The Oxford Handbook of Industry Dynamics*, which covers nearly 30 individual industries over time and a variety of different analytical approaches, and Eleanor Westney will discuss what the editors have learned in the process. Takafumi Kurosawa will focus on industry ontology, how scholars and practitioners have understood and used the concept of 'industry' over time. Gary Gereffi builds on decades of pioneering research on industry value chains to identify key factors needed to map value chains from both firm- and country-level perspectives. Building on detailed fieldwork in specific industries, global value chain (GVC) scholars develop insights about industry governance structures and country upgrading trajectories that are useful not only to other academic researchers but also to policymakers and practitioners. John Paul MacDuffie focuses on one of the most intensively researched industries, the auto industry, to discuss how studies of the that industry have affected industry studies more generally and the implications for the challenges of learning across industries.



John Paul MacDuffie - John Paul MacDuffie is Professor of Management at the Wharton School, University of Pennsylvania, and Director of the Program on Vehicle and Mobility Innovation (PVMi) at the Mack Institute for Innovation Management. His career as an industry studies scholar began during MIT's International Motor Vehicle Program with his global research on automotive assembly plants highlighting the human and organizational underpinnings of "lean production"



Takafumi Kurosawa - Takafumi Kurosawa is a professor at Kyoto University specializing in economic history and industrial policy. His research focuses on the development of manufacturing industries and economic structures in Japan and beyond. He has contributed extensively to studies on industrial clusters, regional economies, and historical economic transitions. Kurosawa's work provides valuable insights into the evolution of industrial strategies and their impact on economic growth.



Gary Gereffi - Gary Gereffi is an Emeritus Professor of Sociology and Director of the Global Value Chains Center at Duke University. A pioneer of the global value chains framework, he has authored numerous works on globalization and industrial development. His recent research examines U.S. protectionism, the digital economy, and shifting regional interdependencies.



Eleanor Westney - D. Eleanor Westney is a Professor Emerita at MIT Sloan and York University, known for her research on international business, organizational learning, and R&D globalization. She has held prestigious academic chairs and authored influential works on multinational corporations.

Conference Program: Friday, June 6

ISA Breakfast

7:00am—8:00am

Samberg Conference Center, 7th Floor

ISA RESEARCH SESSIONS

8:00am—9:00am

See Session 8 schedule; includes 7 research streams

ISA SPECIAL SESSIONS - (select one) Samberg Conference Center, 6th Floor

9:15am—10:15am

Track A: Workforce Development

9:15am—10:15am

Track B: Supply Chains & Geography

COFFEE/SNACKS

10:15am—10:45am

Samberg Conference Center, 7th Floor

ISA RESEARCH SESSIONS

10:45am—11:45am

See Session 9 schedule; includes 7 research streams

AWARDS LUNCHEON & CLOSING SESSION

12:00pm—1:00pm

Samberg Conference Center, 7th Floor



Friday, June 6

ISA Breakfast

7:00am—8:00am

Samberg Conference Center, 7th Floor

ISA RESEARCH SESSION 8

8:00am—9:00am

Tang Center (E51, 1st & 3rd Floors)

Sloan (E62, 2nd Floor)

GO6. Regional Development and Policy

E51-145

Chair: Diana Jue-Rajasingh (Rice University)

Cooperatives Across Clusters: Lessons from the Cranberry Industry
Anil (Andy) Hira (Simon Fraser University)

Cross-Sector Partnership Formation for Community-Based Industries
Chenlan Wang (University of Michigan)
Jimin Han (Rice University)
Diana Jue-Rajasingh (Rice University)

Refining Transition: A Just Transition Economic Development Framework for Contra Costa County, California

Jessie Hammerling (UC Berkeley)
Will Toasperm (UC Berkeley)
Laura Schmahmann (UC Berkeley)

Shifting Industrialisation Research Focus from Start-up to Scale-up: Learnings from Chinese photovoltaic industry emergence

Tingrui Zhang (University of Cambridge)
Yongjiang Shi (University of Cambridge)

LM3. Technology and Labor Outcomes

E51-149

Chair: Avner Ben-Ner (University of Minnesota)

Getting Workers on Board with Automation: Evidence from Shipping Container Adoption and Longshore Unions

Jacob Greenspon (University of Oxford)

From Factories to Streets? The Impact of Ridesharing Services on Labor Turnover in US Manufacturing

Yasaman Asayesh (Carlson School of Management, University of Minnesota)
Anant Mishra (Carlson School of Management, University of Minnesota)

Algorithm as Boss or Coworker? Randomized Field Experiment on Algorithmic Control and Collaboration in Gig Platform

Sojung Yoon (Carlson School of Management, University of Minnesota)
Nakyung Kyung (National University of Singapore)
Jason Chan (University of Minnesota)
Yeonseo Kim (Korea Advanced Institute of Science & Technology)

A High-Performance Work Approach to Navigating Organizational Paradox in the Gig Economy

Ayaj Rana (Cornell University)



IE9. Innovation Policy & Entry

E51-151

Chair: Michael Burstein (Benjamin N. Cardozo School of Law, Yeshiva University)

"Critical Technologies" and the Law and Geopolitics of Innovation Policy

Michael Burstein (Benjamin N. Cardozo School of Law, Yeshiva University)

Fiona E. Murray (MIT Sloan School of Management)

Systemic Innovation emerged from Collective Inaction: The Case of Japan's hydrogen station industry

Tomonari Komiyama (Hitotsubashi University)

Knowledge relatedness and firm entry: theory and empirical evidence

Roberto Fontana (University of Pavia)

Sung Hoon Lee (Neoma Business School, France,)

Franco Malerba (Bocconi University, Italy)

Building a Wall Around Science: The Effect of U.S.-China Tensions on International Scientific Research

Jiusi Xiao (Claremont Graduate University)

Britta Glennon (University of Pennsylvania)

Robert Flynn (Boston University)

Raviv Murciano-Goroff (Boston University)

IE15. Challenges and Opportunities in the Life Sciences

E51-372

Chair: Arvids A. Ziedonis (Boston University)

Pre-Entry Knowledge of Entrepreneurs and Market Strategy

Seojin Kim (Drexel University)

When Do Firms Provide Early Access to Investigational Drugs? Evidence from Expanded Access in the Oncology Drug Market 1990-2020

Sungyong Chang (London Business School)

Sukhun Kang (University of California, Santa Barbara)

Fuel of Interest or Shackle of Restriction: The Dual Role of Intellectual Property Rights in Shaping Scientific Research

Sina Khoshokhan (University of Colorado, Boulder)

Arvids A. Ziedonis (Boston University)

Should research policy be concerned about predatory journals?

Heather Park (KAIST)

Jeffrey Furman (Boston University)



Friday, June 6

IE16. Small(er) Firms in Emerging Markets

E51-376

Chair: Christopher Eaglin (Fuqua School of Business, Duke University)

Who Wins When the Power Goes Out: Digital Technology, Electricity Blackouts, and Firm Performance

Christopher Eaglin (Fuqua School of Business, Duke University)

Rowan Clarke (Harvard Business School)

Jun Wong (University of Chicago)

Zachary Kuloszewski (University of Chicago)

Gendered Work and Earnings Differentials in Microenterprise

Natalie Carlson (Wharton School of Business)

Geoffrey Borchhardt (University of Oregon)

Beyond Technology Adoption: The Critical Role of Digital Technology Integration in SME Growth and Scalability

Valentina Assenova (Wharton School of Business)

Yuheng Ding (World Bank)

Audra Wormald (University of North Carolina - Chapel Hill)

The Sources of Disparities in Investments: An Experiment with Avatars

Amisha Miller (New York University - Stern School of Business)

OP2. Innovation and Sustainability in Industrial Operations

E51-361

Chair: Abhishek Roy (Temple University Fox School of Business)

Network Ethnography in Industry Studies: Exploring Network Motifs and Innovation Outcomes

Tomas Harrington (University of East Anglia, UK)

Jagjit Singh Srai (University of Cambridge)

Nitin Joglekar (Villanova University)

Sriram Narayanan (Michigan State University)

Who adopts Cleantech? Evidence from 30 million truck inspections

Alex Scott (University of Tennessee Knoxville)

Andy Balthrop (University of Tennessee Knoxville)

David Cantor (Iowa State University)

Fertilizer Pollution Mitigation is a Newsvendor Problem

Canberk Ucel (ESSEC Business School/INSEAD)

Enver Yucesan (INSEAD)

Natalie Carlson (The Wharton School, University of Pennsylvania)

Collaborative New Product Development: Co-creating with a Shared Supplier in the Presence of a Competitor

Abhishek Roy (Temple University Fox School of Business)

ISA SPECIAL SESSIONS - (select one) Samberg Conference Center, 6th Floor

9:15am—10:15am

Track A: Workforce Development

9:15am—10:15am

Track B: Supply Chains & Geography

COFFEE/SNACKS

10:15am—10:45am

Samberg Conference Center, 7th Floor



Friday, June 6
9:15—10:15 am

Panelists' Bios

Special Sessions | Workforce Development

What can policymakers and educational institutions do to ensure that workers can thrive in a changing technological environment? For decades, “college for all” has been the policy response in the United States. However, enrollment in U.S. higher education – both four-year and two-year colleges – has declined substantially since 2010. During the same period, there has been new evidence that independent workforce development programs including “sector partnerships” can pay dividends for their graduates. This panel will offer a dialogue between government, non-profit, and academic perspectives on the changing demand for skills in the workforce – and the best models for ensuring that workers can obtain those skills.



Ben Armstrong - Ben Armstrong is the Executive Director of MIT's Industrial Performance Center and a Research Scientist, co-leading the Work of the Future initiative. His research examines how workers, firms, and regions adapt to technological change, with projects focused on U.S. manufacturing workforce development and regional economic strategies.



Christophe Combemale - Christophe Combemale is an Assistant Research Professor in Engineering and Public Policy at Carnegie Mellon University. His research explores the impact of technology choices and process design on skill demand, as well as workforce supply chain strategies to meet industry needs. He contributes to an NSF-funded pilot program focused on assessing critical technologies for U.S. competitiveness and advises the Allegheny County Department of Human Services on workforce development initiatives.



Layla O'Kane - Layla O'Kane is the Senior Director of Data Products at the national nonprofit Opportunity@Work. She plays a vital role in driving field-level impact and enabling data-driven decision-making that can accelerate economic opportunity for STARs. O'Kane joined Opportunity@Work from the pioneering labor market analytics firm Lightcast, where she served as Senior Economist and Research Director. Her work has been featured in the New York Times, Wall Street Journal, NPR, and other national media. O'Kane holds a MPA in International Development from the Harvard Kennedy School and a BA in Economics and in International Relations from the University of Pennsylvania.



Julia Pollak - Julia Pollak is the Chief Economist at the U.S. Department of Labor, serving under Secretary Lori Chavez-DeRemer and President Donald Trump. In this role, she leads data-driven analysis to inform labor policy, with a focus on expanding opportunity, supporting innovation, and strengthening the dignity of work. Previously, she was Chief Economist at ZipRecruiter, where she analyzed labor market trends using real-time platform data. Her work has appeared in The New York Times, Wall Street Journal, NPR, and Bloomberg. She has also served as an Assistant Policy Analyst at the RAND Corporation, taught economics at Pepperdine University, and served as a drilling U.S. Navy Reservist from 2011 to 2022. Julia holds a bachelor's degree cum laude in economics from Harvard University and an M.Phil. in policy analysis from the RAND Graduate School.

Friday, June 6
9:15—10:15 am

Panelists' Bios

Special Sessions | Supply Chains & Geography

Supply chains are in flux yet again but now being driven by new harsh geo-strategic competition. So what has motivated governments to push on from their initial supply chain policy resilience initiatives, a new development itself following the pandemic, to extending their focus to national security and large scale reindustrialisation? In the US we have seen unprecedented levels of tariffs to incentivise firms to onshore but these sector agnostic moves alone will be insufficient. Will these transformations put ESG firmly on the back-burner or will new regulatory moves (environmental, human- rights and geo-political) drive further constraints on product and component sourcing?

Our expert panel will explore what additional industrial policy moves might influence supply chain relocation at scale drawing on findings from assembly and process-based industries. The panel will discuss why we need a more nuanced view of supply chain reconfiguration – one that captures at a sector level, future developments in international supply network structure, next generation production technologies that will change economies of scale and product architectures, and lessons from alternative buyer-supply relationships.



Moderator: Jagjit Singh Srail - Dr. Jag Srail is a Director of Research in the Department of Engineering, University of Cambridge, and Head of the Institute for Manufacturing's (IfM's) Centre for International Manufacturing. He is also Co-Chair of the World Economic Forum's Council on Advanced Manufacturing Value Chains. Jag's research involves working closely with industry in the analysis, design and operation of international supply networks. Research areas include digital transformation of supply chains, supply network reconfiguration driven by changes to markets, technologies, and business strategy, supply network resilience and sustainable supply. Previous to IfM, Jag held senior management roles in Unilever.



Dame Fiona Murray - Fiona E. Murray is the Associate Dean of Innovation at the MIT Sloan School of Management and the William Porter (1967) Professor of Entrepreneurship. She co-directs MIT's Innovation Initiative and serves as Vice Chair of the NATO Innovation Fund. Her research focuses on transforming investments in science and technology into deep-tech ventures that address global challenges. She has advised governments and organizations on innovation policy and was awarded a CBE for her contributions to entrepreneurship in the UK.



Tim Sturgeon - Timothy J. Sturgeon is a Senior Researcher at MIT's Industrial Performance Center. His research focuses on global integration and digital transformation, particularly in offshoring and outsourcing within the electronics, automotive, and services industries. He has made significant contributions to Global Value Chain (GVC) theory and collaborates with policymakers worldwide on effective responses to globalization. His work explores how evolving technologies and business models shape industrial and economic linkages between developed and developing economies.



Susan Helper - Susan Helper is the Frank Tracy Carlton Professor of Economics at Case Western Reserve University. She has served as Chief Economist at the U.S. Department of Commerce and as a Senior Advisor for Industrial Strategy at the White House Office of Management and Budget. Her research focuses on supply chain globalization, U.S. manufacturing revitalization, and reshoring strategies. She has been a visiting scholar at institutions like Oxford, Harvard, and MIT and has contributed to policy discussions on economic innovation and industrial strategy.



Monica Gorman - Monica Gorman is a Managing Director at Crowell Global Advisors, the government relations and public policy affiliate of Crowell & Moring. She brings extensive experience in industrial policy, supply chain resilience, and international trade, having served as Special Assistant to the President for Manufacturing and Industrial Policy and as Deputy Assistant Secretary of Commerce for Manufacturing in the Biden Administration. Previously, she held senior compliance roles at New Balance, American Eagle Outfitters, and Gap Inc., focusing on fair labor practices, tariffs, and sustainability.

Friday, June 6

ISA RESEARCH SESSION 8

10:45am—11:45am

Tang Center (E51, 1st & 3rd Floors)

Sloan (E62, 2nd Floor)

PP12. Institutions and Policy in a Changing World

E51-145

Chair: Siqi Zheng (MIT)

The Impact of Trade Policy Uncertainty on Export Resilience Evidence from China

Vigdis Boasson (Central Michigan University)

Junli Zhao (Donghua University)

Emil Boasson (Central Michigan University)

Yuxin Zhang (Donghua University)

How the US-China Trade War Accelerated Urban Economic Growth and Environmental Progress in Northern Vietnam

Siqi Zheng (MIT)

Matthew Kahn (USC)

Wen-Chi Liao (NUS)

Export Intensity and Firm Size in Baltic and Nordic Countries: Insights into Services and Wood Manufacturing Industries

Riina Kerner (Estonian Business School)

Birgit Linnamäe (Estonian Business School)

IE13. Science of Innovation

E51-361

Chair: Matteo Tranchero (The Wharton School, University of Pennsylvania)

Instrumental Burden: Rising Capital Intensity in Science and Consequences for Innovation

Jungkyu Suh (New York University)

Government Research

Dan Traficonte (Syracuse University)

Finding Diamonds in the Rough: Data-Driven Opportunities and Pharmaceutical Innovation

Matteo Tranchero (The Wharton School, University of Pennsylvania)

LM4. Workforce Skills and Development

E51-151

Chair: Arvind Karunakaran (Stanford University)

Artificial Intelligence and Workforce Skill Development

Arvind Karunakaran (Stanford University)

Roshni Raveendhran (University of Virginia)

Tami Kim (Dartmouth College)

A Model for Tracking Occupational Insights: Rapidly Generating Preliminary Quantitative Occupational Attribute Vectors for Emerging Occupations

Wilson Martinez Diaz (Carnegie Mellon University)

Erica Fuchs (Carnegie Mellon University)

Christophe Combemale (Carnegie Mellon University)

Poach, Reskill, Import: How Megafactories Source Skilled Labor

Daniel Stock (Carnegie Mellon University)

Christophe Combemale (Carnegie Mellon University)



IE12. Scaling & Firm Growth

E51-372

Chair: Claudia Gonzalez-Brambila (Instituto Tecnológico Autónomo de México)

Evolving Dynamics in Latin America's Venture Capital Landscape: Shifts in Investment Stages, AI Growth, and Colombia's Rise

Claudia Gonzalez-Brambila (Instituto Tecnológico Autónomo de México)

The Mid-Sized Market Trap in Entrepreneurial Scaling

Ed Saiedi (BI Norwegian Business School)

Nataliya Langburd Wright (Columbia University)

Overcoming scaling-risk in non-incremental product innovations in manufacturing companies

Anan Sheth (Cal Poly - San Luis Obispo)

Emergence and scale-up of complementary innovation ecosystems in the context of energy transition

Anurag Wasnik (Simon Fraser University)

Elicia Maine (Simon Fraser University)

PP1. Government R&D and Technology Transfer

E51-376

Chair: Shiri Breznitz (University of Toronto)

The Social Returns to Public R&D

Andrew Fieldhouse (Texas A & M)

Karel Mertens (Federal Reserve Bank of Dallas, CEPR)

Moonshots and Misfires: Lessons and Limits of the ARPA Model of Innovation

Graham Griffin (RAND Corporation)

Erica Fuchs (Carnegie Mellon University)

Jason Matheny (RAND Corporation)

Henry Willis (RAND Corporation)

Transforming Collaboration Networks: The Role of Government Funding in the Development of a Novel Field

Shiri Breznitz (University of Toronto)

Paige Clayton (Georgia Institute of Technology)

Mircea Gherghina (University of Toronto)



Friday, June 6

IE8. Impact of Social Change & Crises on Innovation

E62-221

Chair: Douglas Hannah (Boston University)

Entrepreneurial organizing in a world on fire: Alternative venture formation pathways in response to crisis

Douglas Hannah (Boston University)
Valerio Iannucci (Boston University)

Rethinking Sociotechnical Innovation Barriers Through an Enabling Innovation Model

Waire Olawolu (Purdue University)
Abhishek Ajmani (Purdue University Institute for Innovation Science)
Lourival Monaco (Department of Agricultural Economics, Purdue University; DIAL Ventures)
Allan Gray (Department of Agricultural Economics, Purdue University; DIAL Ventures)
Joseph Sinfield (Purdue University Institute for Innovation Science)

Trade Disruptions, Entrepreneurship, And Social Change: Social Impacts Of New Industrial Entrepreneurship In Early 20th Century China

Sunasir Dutta (University of Minnesota)
Caiwei Zhang (University of Minnesota)

Sharing, Staging, and Knowing: Software development as socially contextualized practice

William Benton (Virginia Commonwealth University)

IE3. Experimentation & Feedback

E51-361

Chair: Cameron Miller (Syracuse University)

The Experimentation and Reputation Dilemma Associated with Digital Rating Systems: Evidence from the Apple App Store

Cameron Miller (Syracuse University)
Shiva Agarwal (University of Texas at Austin)

Organizing for Experimentation: Does Hierarchy Help or Hurt Experimentation in New Ventures?

Anavir Shermon (University of Texas at Dallas)
Todd Hall (University of Kansas)
Ryan Allen (University of Washington)
Travis Howell (Arizona State University)

Entrepreneurial Experimentation, Strategic Choices, and Value Creation: A Theoretical Foundation

Hyeonsuh Lee (West Virginia University)
Yong Li (University of Nevada - Las Vegas)
Joseph T. Mahoney (University of Illinois at Urbana-Champaign)
Lenos Trigeorgis (Durham University)

AWARDS LUNCHEON & CLOSING SESSION

12:00pm—1:00pm

Samberg Conference Center, 7th Floor



Industry Studies Association

BOARD OF DIRECTORS

President | **John Gray** (The Ohio State University)

Vice President/President-elect | **Edward Anderson** (University of Texas)

Past President | **Tonya Boone** (College of William and Mary)

Chief Fiscal Officer | **John Paul MacDuffie** (University of Pennsylvania)

Treasurer | **Jeff Shockley** (Virginia Commonwealth University)

Early Career Development Committee | **Jeff Furman** (Boston University)

Awards | **Raja Roy** (New Jersey Institute of Technology)

Industrial Policy | **Andrew Reamer** (George Washington University)

Conference Chair 2025 | **Hiram Samel** (Massachusetts Institute of Technology)

Non-U.S. Strategy and Programming | **Benn Lawson** (University of Oxford)

Membership | **Darcy K. Fudge Kamal** (California State University)

Program Manager | **Renae Sullivan** (Industry Studies Association)

INDUSTRY STUDIES CONFERENCE COMMITTEE (ISCC)

Conference Chair 2025 | **Hiram Samel** (Massachusetts Institute of Technology)

Conference Chair 2026 | **John Paul Helveston** (George Washington University)

International Conference Chair 2026 | **Benn Lawson** (University of Oxford)

Conference Chair 2027 | **Anant Mishra** (University of Minnesota)

ISA President | **John Gray** (The Ohio State University)

Program Manager | **Renae Sullivan** (Industry Studies Association)

Research Stream Chairs:

Policy—**Allison Forbes** (Center for Regional Economic Competitiveness)

Labor—**Tashlin Lakhani** (Cornell University)

Innovation & Entrepreneurship—**Cameron Miller** (Syracuse University)

General—**Richard Wang** (Babson College)

Energy—**John Paul Helveston** (George Washington University)

Operations—**Anant Mishra** (University of Minnesota)

Healthcare—**Dennie Kim** (University of Virginia)

Thank you to all the reviewers and judges!



THANK YOU!! to our Conference Sponsors



William and Phyllis

MACK INSTITUTE
for INNOVATION MANAGEMENT



**THE OHIO STATE
UNIVERSITY**

FISHER COLLEGE
OF BUSINESS



Interested in sponsoring the Industry Studies Association Annual Conference?
Contact: renae.sullivan@industrystudies.org



Join us for the 2026 ISA International Conference

Saïd Business School, Oxford, UK

3–5 September 2026



Join us June 2026 in

Washington, D.C.

Industry Studies Association
Annual Conference



www.industrystudies.org